

**St Thomas Church Graveyard  
Southern Part – Centre**

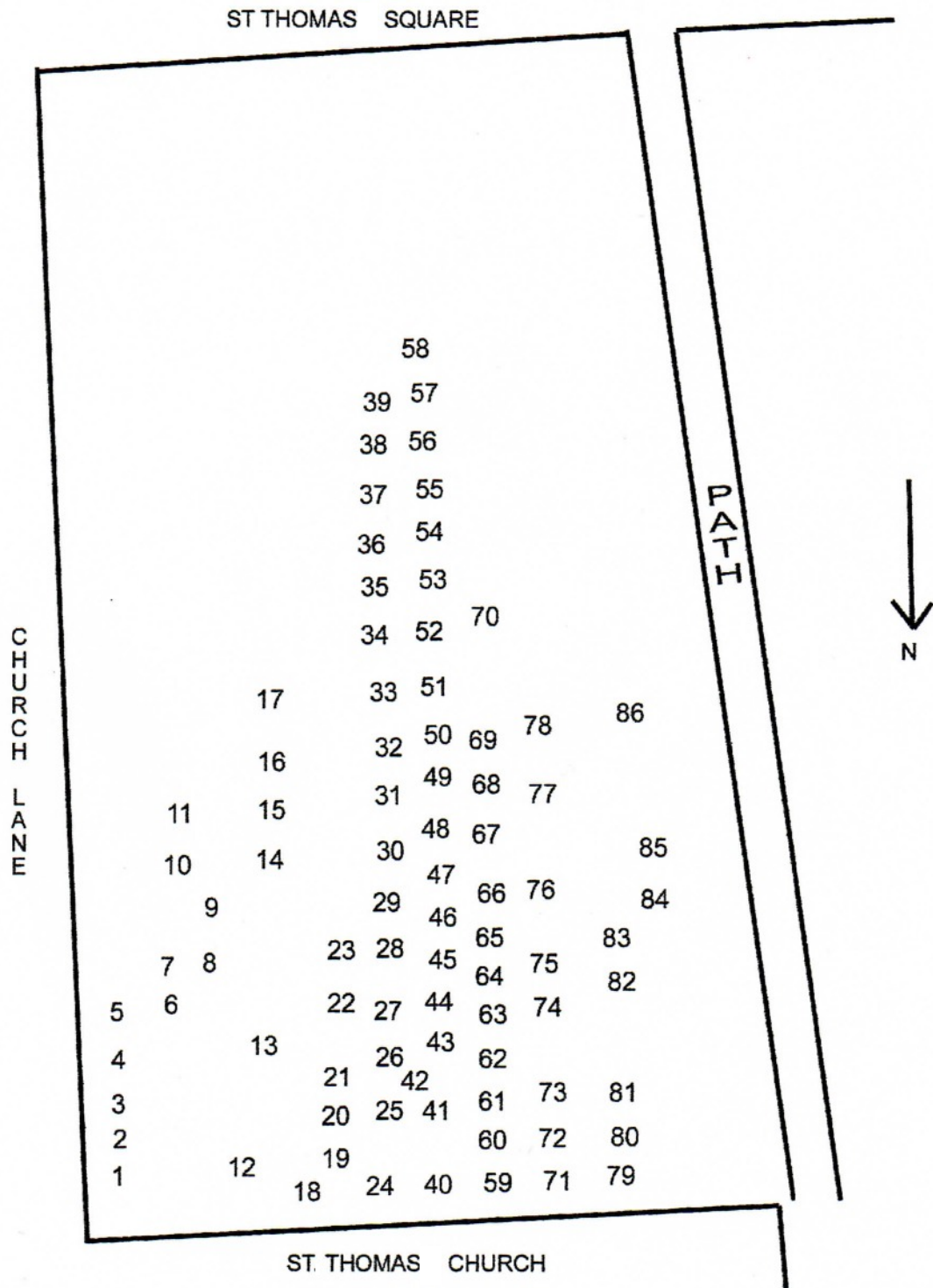

This map has been produced by Ryde Social Heritage Group based on the work of Jack Wheeler in 1975. The map shows the position of the memorials in the southern part of the graveyard at that time and should be used together with the alpha index giving the list of grave names. In 1986 the Garden of Rest was created and a number of headstones either found damaged or deemed unsafe were reused as paving around the new seating areas and others moved to new positions. This map does not reflect the current positions of the headstones.